

# Instructions

**Parents, be sure to read these instructions as misuses of batteries may lead to overheating, rupture, fire, and liquid discharge.**

- Do not use battery types other than those that have been provided. .
- Properly insert the battery per the indicated positive (+) and negative (-) terminals.
- Always switch the power OFF on vehicle and controller, and remove batteries when not in use.
- If the rechargeable battery becomes wet, please dry it off immediately to avoid short circuiting.
- In the event of a short circuit, refrain from touching.
- Never place the batteries into fire or water. Do not disassemble, weld, or solder.
- Do not place near fire. Do not recharge or store in places with high temperatures or humidity.
- Protect against electric shock – do not touch the charger when hands are wet.
- Always unplug the charger when not in use.
- Hold the base of the charger when unplugging from socket.
- Do not bend, twist, or yank the power cord.
- Do not place furniture, electric appliances, or other items on the power cord.
- If the power cord is damaged (loose or broken connection), immediately cease its use and replace the AC power supply.
- Plug in a household 100V outlet.
- If liquid discharged from the battery gets into the eye, immediately rinse with water and see a doctor. Immediately wash any skin or clothing that comes into contact with discharged liquid.

## Please take the following precautions:

- Play in a safe area away from traffic and crowds.
  - Do not ram the toy or shake it while it is in use.
  - Keep hair and clothing away from the wheels to avoid entanglement. Do not put fingers in or around the wheels during operation.
  - Do not recommend children under the age of 6 to operate the vehicle.
- Small parts, not suitable for children under age 3.
- Do not disassemble or modify this product.

## Radio Frequency:

- Simultaneous operation within proximity of other radio-controlled items using the same frequency can result in operation errors.
- Occasionally there may be other types of radio interferences. If operating errors are occurring then play in an area far enough away from the interference source.

## Conditions of usage:

- After running in dirt, mud or sand, it is best to rinse off debris after turning car and controller power off.
- Do not submerge the vehicle under water as you may damage it.
- When the vehicle is used over a continuous period of time, it may become slow or cease operation due to the battery overheating. In this case, turn power switches off and let it rest for 15 minutes and then resume operation. If this does not work, your battery pack likely needs to be recharged.
- In the event a tire loosens when running on rough terrain, simply remount the tire over the wheel and inflate. Included is a tire measurement gauge. Keep all tires inflated at this size.
- After traveling in water remove the 7.4V battery pack and wipe off any water until the battery pack and battery compartment dry.

In the event the car slows down or stops on rough terrain, this may represent the safety features may have been switched on because of the high car in high temperature. Please rest the car for 15 minutes to allow it to cool down.

## Product specifications

- Age: 6 and up. Small parts, not suitable for children under age 3.
- Radio frequency: 2.4GHz
- Maximum operation distance: Approx. 40 feet
- Functions: Forward, reverse, turn left/right, 360 degree left/right rotation and stop.

Controller Battery: 2 X 1.5V AA/LR6 Heavy Duty battery  
 Battery lifetime: Approx 8 hours of continuous use

Car Battery: 1 X 7.4V battery pack  
 Running time: Approx 8 minutes of continuous use  
 Charging time: Approx 4 hours



**Video Here !**

## Recycle the rechargeable battery:

This product uses recyclable rechargeable batteries. Please recycle the rechargeable battery pack once you are finished with it by taking it to a facility that accepts spent batteries. Please return spent 9V battery to a recycling center as well.

## What to do in cases of possible malfunction

Situation	Cause	Solution
Car does not move	The car or controller battery was not properly inserted. The 7.4V battery pack is drained of power. The controller battery is drained of power. The car or controller power was switched OFF.	Re-insert the battery correctly as indicated Charge the 7.4V battery pack Change the battery Switch the car or controller power ON
Car moves uncontrollably on its own	The 7.4V battery pack is drained of power. The controller battery is drained of power. Radio interference due to wireless controller products operating on the same frequency nearby The car is malfunctioning due to radio interference.	Charge the 7.4V battery pack Change the battery Move to a new location or play at another time Move to a new location or play at another time
The indicator light (red light) on the controller does not light up	The controller battery is drained of power.	Change the battery
The car slows down or stops on rough terrain	The safety features have switched on due to the high car temperature.	Rest for 15 minutes to cool the car

## Contents and descriptions

Car: X1  
Controller: X1  
Tire measure: X1

1.5V AA/LR6 battery: X2  
7.4V battery pack: X1  
USB Charger: X1

Pump: X1  
Pump needle: X1  
Instruction manual: X1

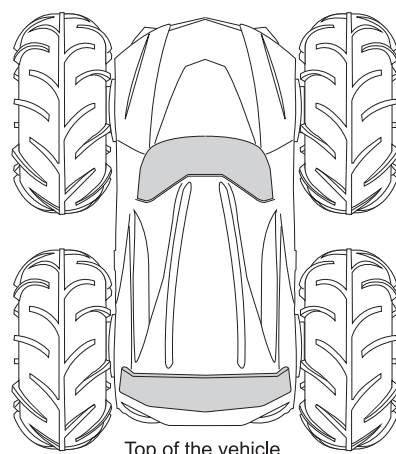

Top of the vehicle

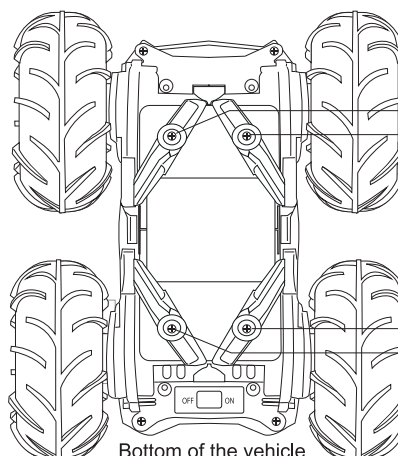

Bottom of the vehicle

Battery Cover Lock A  
Battery Cover Lock B

Battery Cover Lock C  
Battery Cover Lock D

## Car Battery Installation

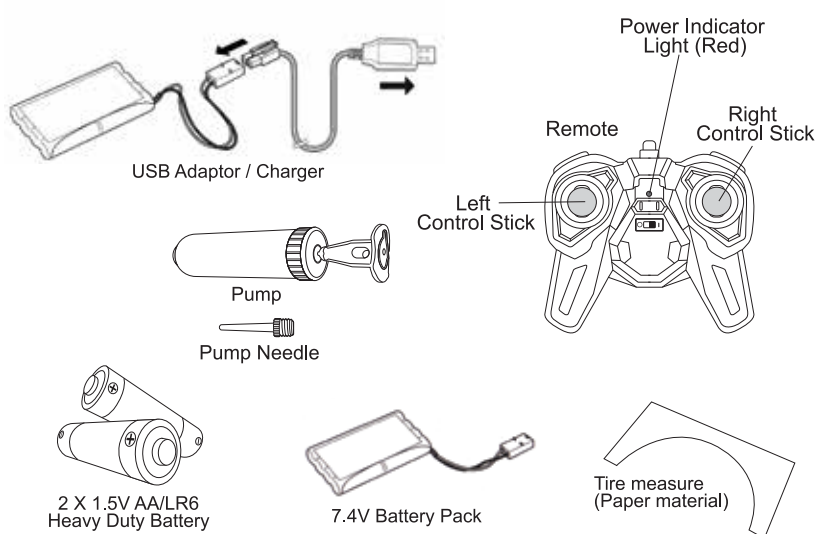
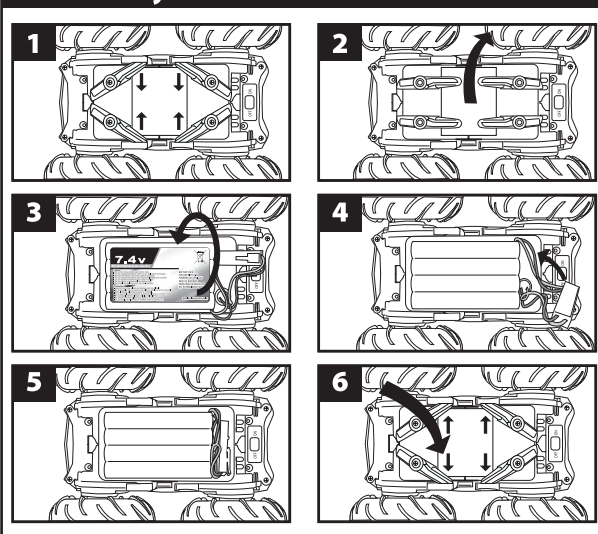

## Controller Battery Installation

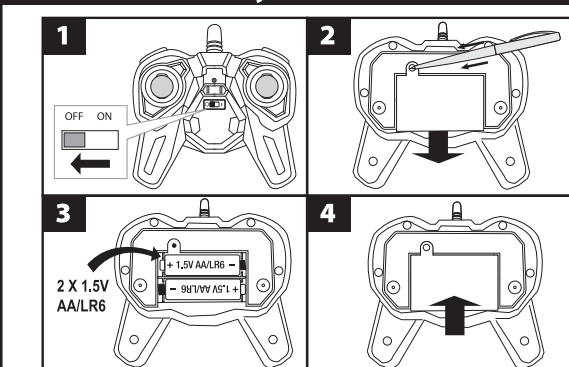

Installing controller battery

1. Check that the controller's power is switched OFF.
2. Open the battery compartment by pushing lightly on the cover in the direction indicated.
3. Insert the 2 X 1.5V AA/LR6 batteries per the indicated positive (+) and negative (-) terminals as shown.
4. Close the battery compartment.

## Pump Installation

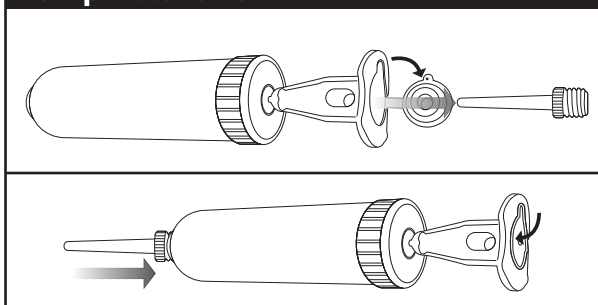

## Charging The Battery Pack

Attention:

1. Allow battery to charge for a minimum of 8 hours on the initial two charges. Subsequent charges require only 4 hours.

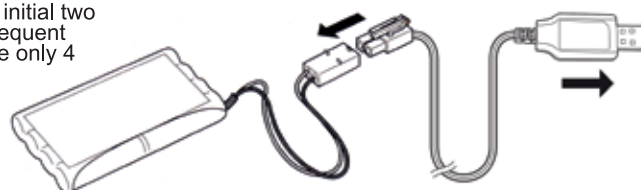

2. Do not charge any battery other than the one provided. Only 7.4V battery packs should be charged in the charger.

3. The battery may become warm while charging. This is normal.

4. It is best to recharge after the battery pack has been completely drained of power.

5. Place the charger in eye sight when charging to confirm that the 7.4V battery pack is charging normally.

## Tires Check

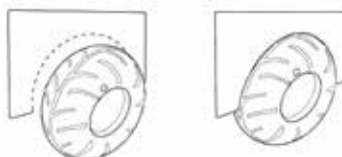

**Check tire size:**

Use the tire measure provided to measure the size of the tires (approximately 4.7" diameter). If the tire is too small, then pump the tire to the appropriate diameter. Do not over inflate as it will interfere with your car's performance.

**Caution:**  
The car can be easily over-  
turned when operating  
immediately after charging  
the battery. Move the control  
sticks gently to avoid unin-  
tended flips.

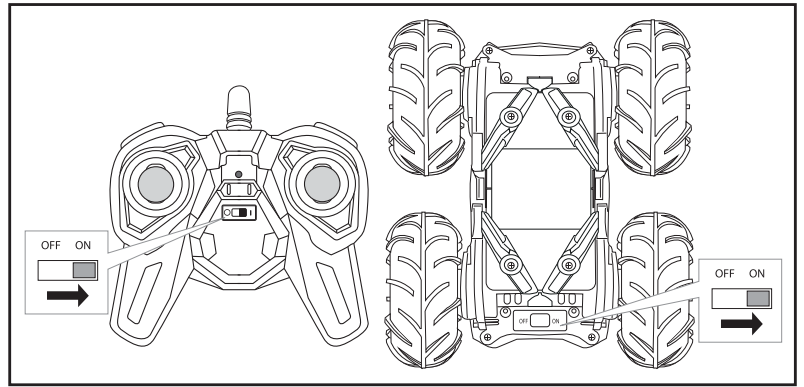

Operating the car:  
1. Switch ON the power of the car and controller.

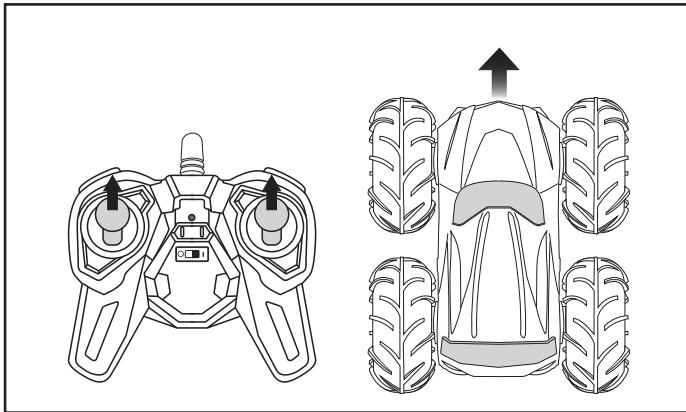

Moving forward:  
Push both control sticks forward to make the car go forward.

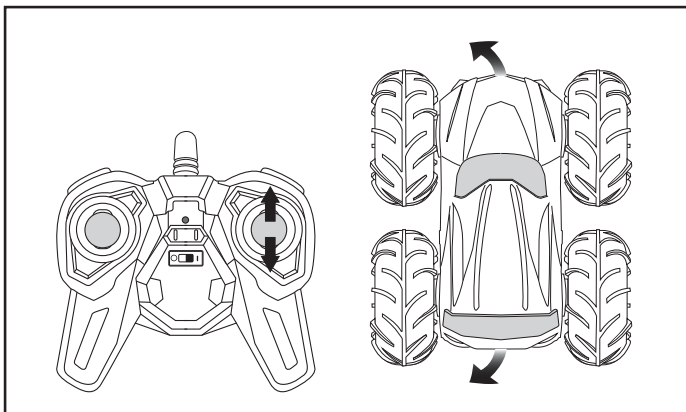
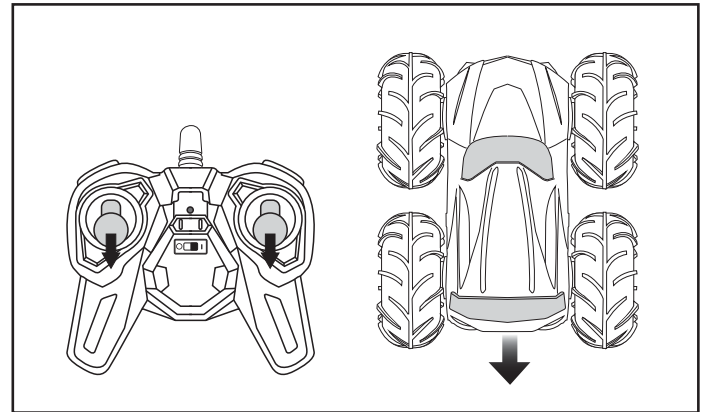

Turning left:  
Push the right control stick forward to make a forward left turn,  
pull it back and toward the bottom left corner to make a reverse left turn.

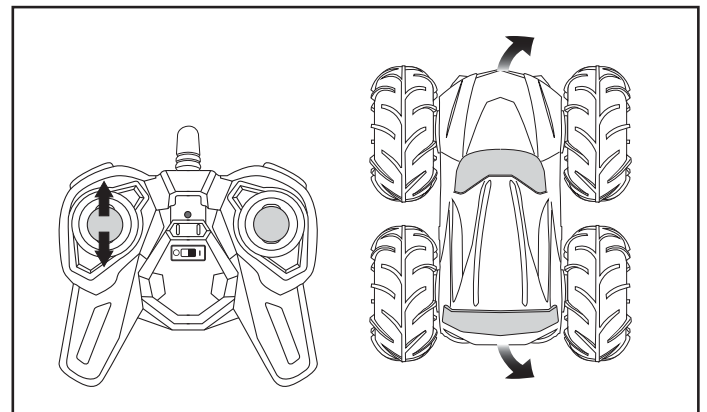

Turning right:  
Push the left control stick forward to make a forward right turn,  
pull it back and toward the bottom right corner to make a reverse right turn.

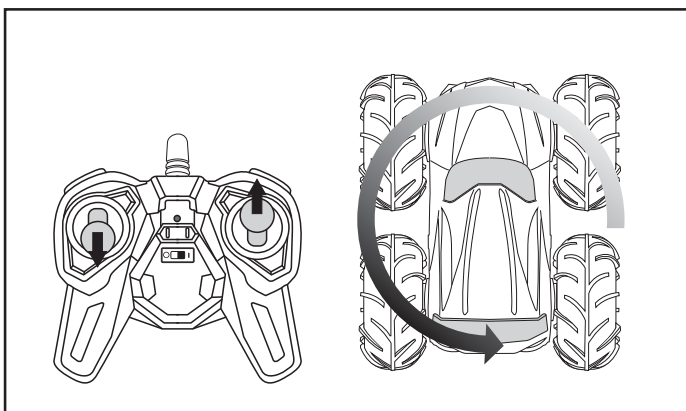

Rotating left (360 degree spin):  
To rotate the car to the left, push the right control stick forward and  
pull the left control stick backward.

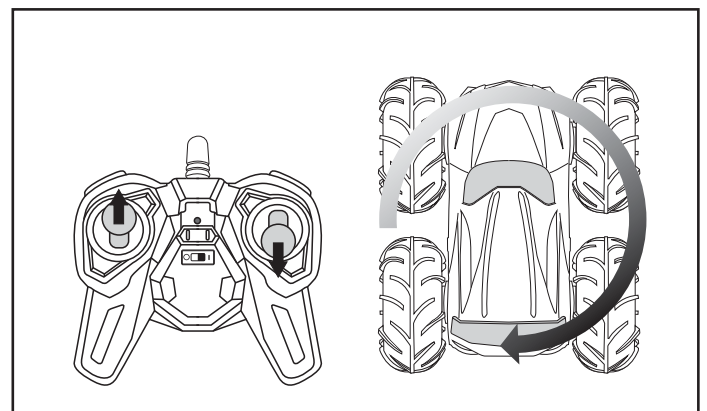

Rotating right (360 degree spin):  
To rotate the car to the right, push the left control stick forward and  
pull the right control stick backward.



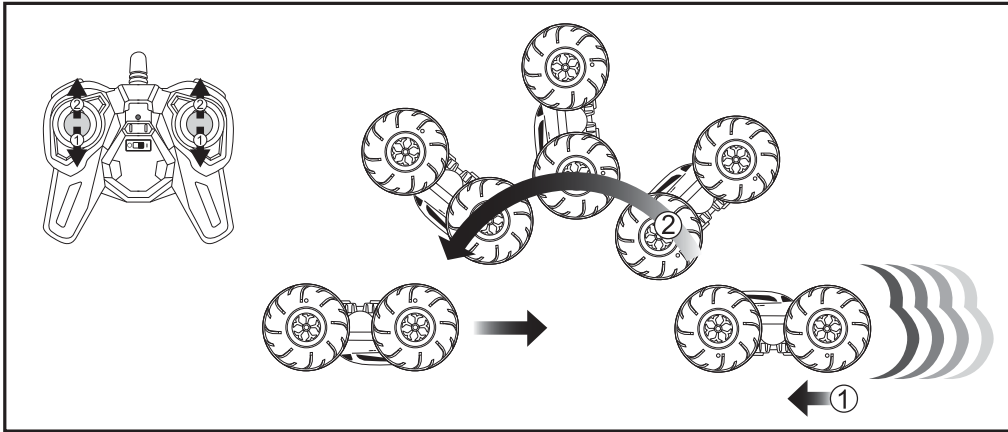

The rear wheels will flip into position before the front wheels.

Flipping the car:  
 1. Pull both control sticks backward to make the car go in reverse.  
 2. Quickly push both control sticks forward to make the car switch to going forward, the car will flip and drive in the opposite direction.  
 3. The vehicle will flip over when switching quickly from forward to reverse.  
 The control sticks work in the opposite directions when driving in reverse.

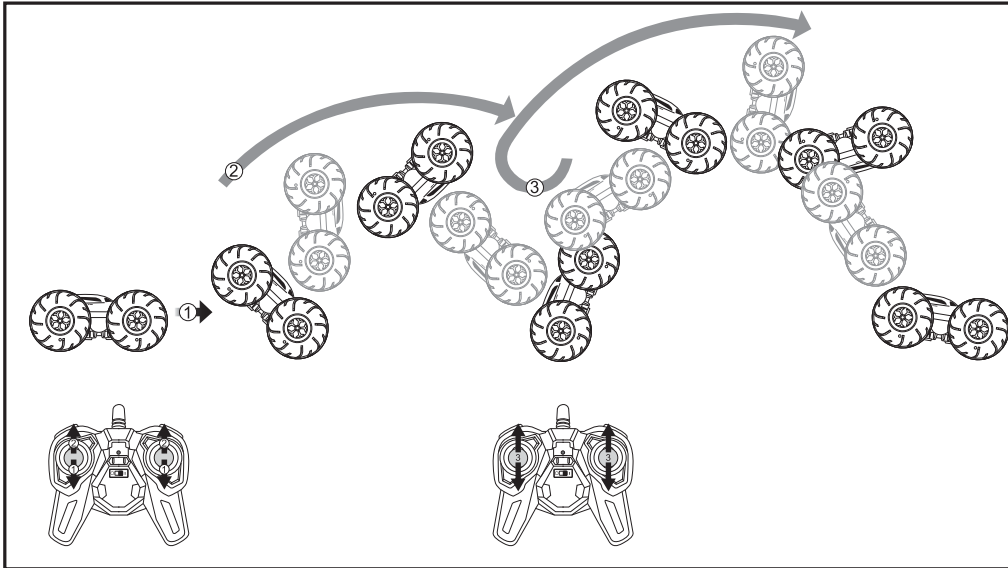

Jumping:  
 1. Push both control sticks forward to make the car go forward.  
 2. Quickly pull both control sticks backward to switch to reverse.  
 3. While the car is reversing, move both control sticks backward & forward repeatedly and the car will face forward and then jump in the air.

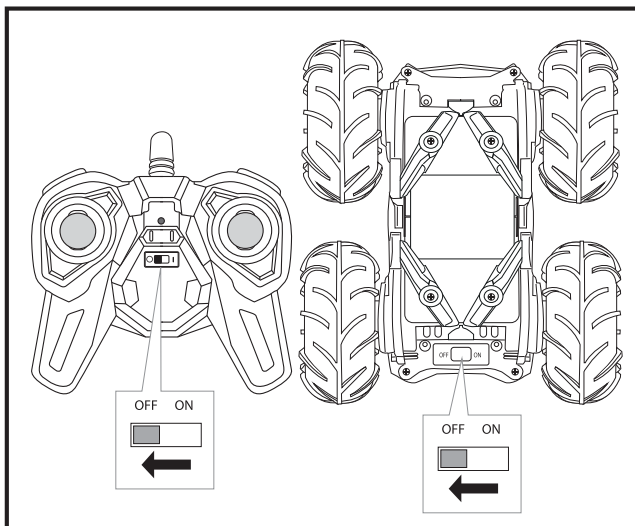

#### Storage:

Do not leave the 7.4V battery pack in the charger for storage.  
 Do not leave the battery pack in direct sunlight or in places with high humidity.  
 Doing so may lead to warping, short circuiting, overheating, fire, or leakage.

The car and controller power must be switched to OFF.  
 The 7.4V battery pack will keep its charge for up to 2-3 months, even when not in use.  
 Remember to recharge the battery pack after long periods of storage.



Fabriqu   par: / Manufactured by:

GOODLY TOYS LIMITED  
 Room 1109, Tower A, New Mandarin Plaza,  
 14 Science Museum Road,  
 TST East, Kowloon, Hong Kong.  
 website : [www.rev-volttoys.com](http://www.rev-volttoys.com)

**Made In China**



# WARNING!

**CHOKING HAZARD - Small parts.**

Not suitable for children under 3 years.



FR/ Mod  les assortis. Vendus s  par  ment.  
 EN/ Assortment sold separately.  
 ES/ Modelos combinados. Vendidos por separado.  
 NL/ Diverse modellen. Worden afzonderlijk verkocht.  
 DE/ Verschiedene Modelle. Werden separat verkauft.  
 IT/ Vari modelli. Venduti separatamente.



ATTENTION  
 WARNING  
 ADVERTENCIA  
 WAARSCHUWING  
 ACHTUNG  
 AVVERTENZA

